

SINGER

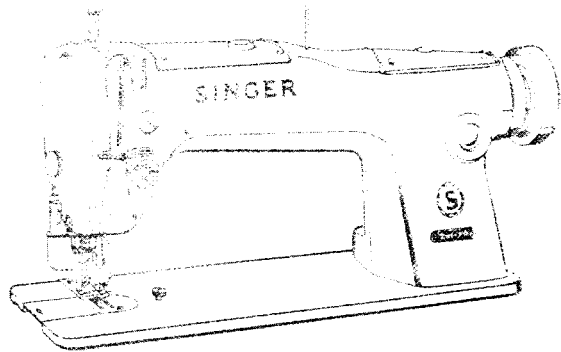

PARTS 281-20

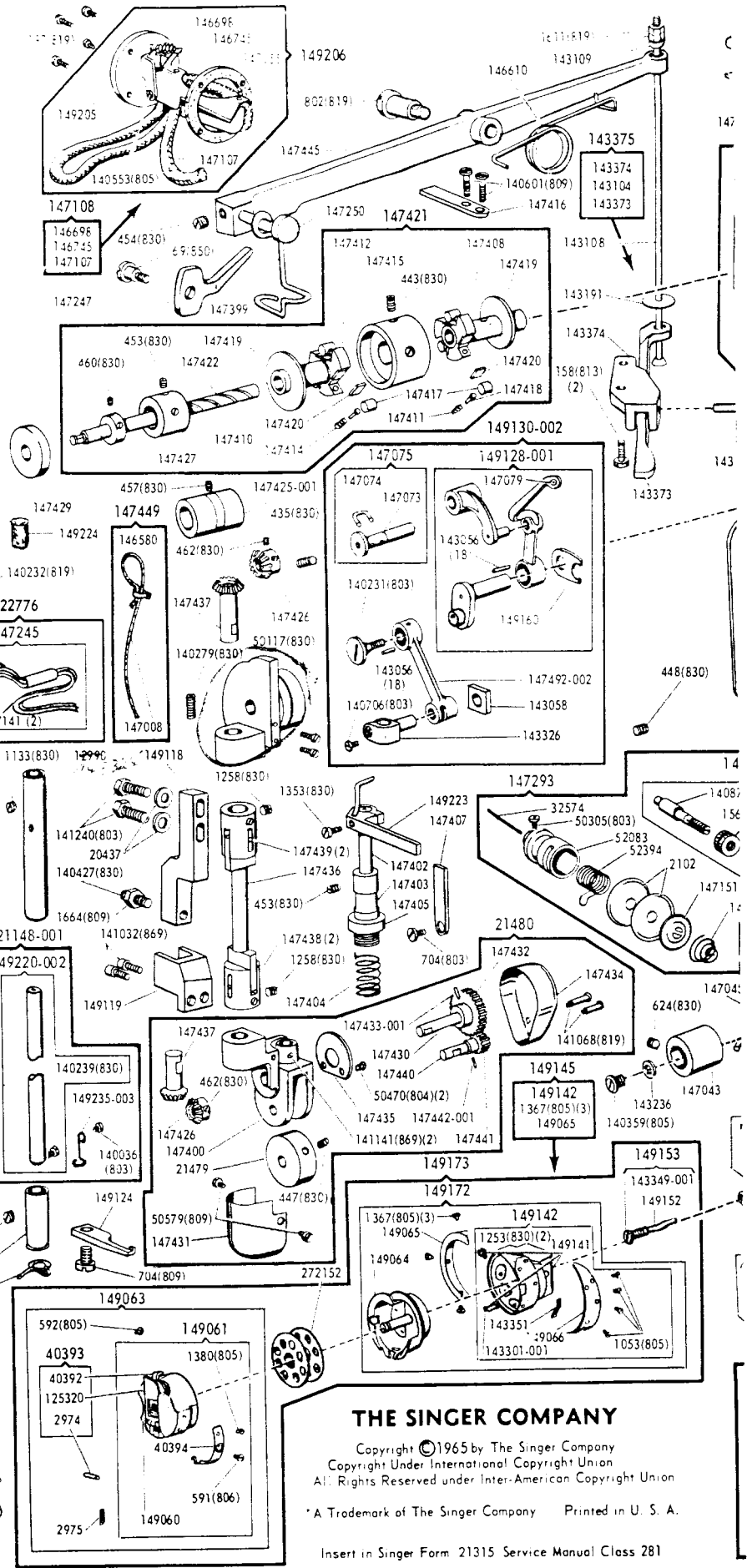

THE SINGER COMPANY

Copyright ©1965 by The Singer Company
Copyright Under International Copyright Union
All Rights Reserved under Inter-American Copyright Union

A Trademark of The Singer Company Printed in U. S. A.

Insert in Singer Form 21315 Service Manual Class 281

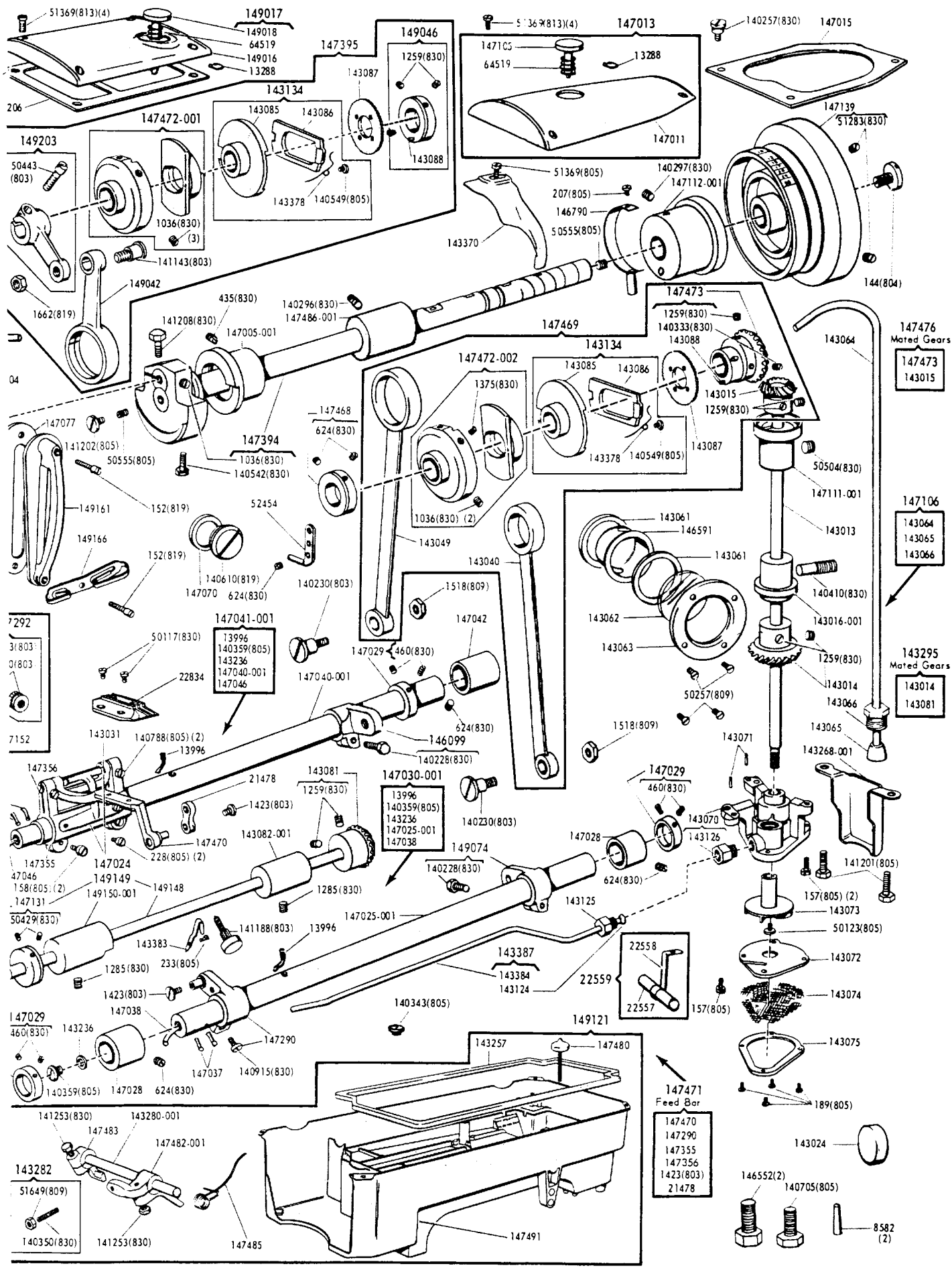

NUMERICAL LIST OF PARTS FOR 281-20 MACHINE

NUMBER	DESCRIPTION	NUMBER	DESCRIPTION	NUMBER	DESCRIPTION
69(850)	Presser Bar Lifter Hinge Screw	624(830)	Arm Shaft (horizontal) Thrust Collar Set Screw(2)	12329	Tension Releasing Lever Spring
144(804)	Arm Shaft (horizontal) Screw (back)	691(850)	Throat Plate Screw(2)	12398	Tension Releasing Lever Hinge Pin
152(819)	Thread Take-up Lever Guard and Thread Eyelet and Thread Guard Screw (front of arm)	704(809)	Rotating Hook Bobbin Case Holder Position Bracket Screw	12431(819)	Bed Slide
152(819)	Face Plate Screw(2)	704(803)	Feed Roll Bracket Shaft Guide Bracket Holder Screw	12432	Bed Slide complete, Nos. 4307, 12431(819) and two 725(819)
152(819)	Thread Take-up Lever Guard Screw	725(819)	Bed Slide Spring Screw(2)	12990	Needle Bar Bushing (upper)
157(805)	Oil Pump (centrifugal) Body Screw(2)	802(819)	Presser Bar and Feed Roll Lifting Lever Hinge Screw	12992	Face Plate 147396-001 with 149111
157(805)	Magnet Retaining Clamp and Oil Pump (centrifugal) Body Screw	1036(830)	Thread Take-up Crank Set Screw	12997	Feed Roll (rubber covered) with 447(830) Note: No. 12997 is furnished on order only
158(813)	Bell Crank Bracket Screw(2)	1036(830)	Feed Eccentric Body Set Screw(2)	13288	Arm Top Cover (front) Stitch Regulator Plunger Spring Stop Ring
158(805)	Feed Bar Carrier Clamping Screw(2)	1036(830)	Feed Roll Eccentric Set Screw(3)	13288	Arm Top Cover (back) Stitch Regulator Plunger Stop Ring
189(805)	Oil Pump (centrifugal) Screen Frame Screw(4)	1053(805)	Rotating Hook Thread Guard Screw(4)	13300	Presser Bar (adjustable) complete, Nos. 14392, 14393 and 141190(869) Note: No. 13300 is furnished on order only
190(805)	Stock Thread Regulator Screw	1133(830)	Needle Bar Bushing (upper) Set Screw	13996	Feed Lifting Rock Shaft Oil Wick
197(819)	Oil Removing Wick (head end) Hinge Plate and Cover Screw(4)	1133(805)	Presser Bar Bushing (lower) Set Screw	13996	Feed Rock Shaft Oil Wick
207(805)	Arm Shaft (horizontal) Flanged Bushing (back) Oil Sump Tube Holder Screw	1133(830)	Needle Bar Bushing (lower) Set Screw	14392	Presser Bar Note: No. 14392 is furnished on order only
217(805)	Thread Take-up Lever Oil Guard Screw	1253(830)	Rotating Hook Set Screw(2)	14393	Presser Foot Seat Note: No. 14393 is furnished on order only
228(805)	Feed Bar Carrier Oil Wick Holder Screw(2)	1258(830)	Feed Roll Driving Shaft (upright) Driving Collar Set Screw(4)	16709	Arm Side Shield Wick Spring Holder
233(805)	Rotating Hook Oil Flow Regulating Thumb Screw Spring Screw	1259(830)	Arm Shaft (upright) Bevel Gear (lower) Set Screw(2)	20437	Feed Roll Guide Bar Screw Washer(2)
435(830)	Thread Take-up Link Hinge Stud Set Screw	1259(830)	Arm Shaft (upright) Bevel Gear (upper) Set Screw(2)	20798-001	Needle Bar Bushing (lower)
435(830)	Arm Shaft (horizontal) Flanged Bushing (front) Set Screw	1259(830)	Feed Roll Feed Regulator Locking Slide Ratchet Wheel Retaining Collar Set Screw(2)	21148-001	Needle Bar (hollow) complete, Nos. 140036(803), 149220-002 and 149235-003
443(830)	Feed Roll Clutch Body Set Screw(2)	1259(830)	Feed Lifting Eccentric Set Screw	21478	Feed Bar Connecting Link
447(830)	Feed Roll Set Screw	1259(830)	Rotating Hook Shaft Bevel Gear Set Screw(2)	21479	Feed Roll (25 Pitch Diamond Knurl) with 447(830) Note: No. 21479 is furnished as regular to machine
448(830)	Thread Take-up Spring Regulator Set Screw	1285(830)	Rotating Hook Shaft Bushing (back) Set Screw	21480	Feed Roll Bracket complete, Nos. 21479, 147400, 147426, 147430, 147431, 147432, 147433-001, 147434, 147435, 147437, 147440, 147441, 147442-001 and two each 50470(804) 50579(809) and 141068(819)
453(830)	Feed Roll Bracket Shaft Bushing Set Screw	1285(830)	Rotating Hook Shaft Bushing (front) Set Screw	22557	Magnet (for removing iron particles from oil)
453(830)	Feed Roll Clutch (bracket) Bushing Set Screw(2)	1353(830)	Feed Roll Bracket Shaft Guide Bracket Clamping Screw	22558	Magnet Retaining Clamp
454(830)	Presser Bar and Feed Roll Lifting Lever Pin Set Screw	1367(805)	Rotating Hook Section Screw(3)	22559	Magnet Retaining Clamp 22558 with 22557
457(830)	Feed Roll Clutch Shaft Arm Bushing (rear) Set Screw	1375(830)	Feed Eccentric Body Position Screw	22766	Arm Side Shield Wick (16 in. long)
460(830)	Feed Roll Clutch Shaft Collar Set Screw(2)	1380(805)	Rotating Hook Bobbin Case Tension Spring Screw	22770	Arm Side Shield complete, Nos. 16709, 22766 and 149230
460(830)	Feed Rock Shaft Collar Set Screw(2)	1423(803)	Feed Bar Connecting Link Cap Screw(2)	22776	Arm Side Shield and Oil Wick Holder, Nos. 22770 and 147245
460(830)	Feed Lifting Rock Shaft Collar Set Screw(4)	1518(809)	Feed Lifting Rock Shaft Connecting Rod Hinge Screw Nut	22834	Feed Dog (20 teeth to the inch), for use with 147158 and 161066
462(830)	Feed Roll Driving Shaft (horizontal) Bevel Gear Set Screw(2)	1518(809)	Feed Rock Shaft Connecting Rod Hinge Screw Nut	22837	Feed Roll (32 rows of spiked teeth, 4 teeth to a row) with 447(830) Note: No. 22837 is furnished on order only
462(830)	Feed Roll Clutch Shaft Bevel Gear Set Screw(2)	1560(803)	Tension Regulating Thumb Nut	32574	Tension Releasing Pin
591(806)	Rotating Hook Bobbin Case Tension Regulating Screw	1560(803)	Tension Regulating Thumb Nut Lock Nut	40392	Rotating Hook Bobbin Case Latch
592(805)	Rotating Hook Bobbin Case Latch Stop Screw	1611(819)	Presser Bar and Feed Roll Lifting Lever Connecting Rod Nut	40393	Rotating Hook Bobbin Case Latch Hinge Nos. 2974, 40392 and 125320
624(830)	Thread Retainer Set Screw	1611(819)	Presser Bar and Feed Roll Lifting Lever Connecting Rod Nut Lock Nut	40394	Rotating Hook Bobbin Case Tension Spring
624(830)	Feed Rock Shaft Bushing (back) Set Screw	1662(819)	Feed Roll Eccentric Connecting Rod Hinge Screw Nut	50027(850)	Feed Roll Plate Screw
624(830)	Feed Lifting Rock Shaft Bushing (back) Set Screw	1664(809)	Feed Roll Guide Bar Adjusting Screw Nut	50117(830)	Arm Side Shield Screw(2)
624(830)	Feed Rock Shaft Bushing (front) Set Screw	2070	Presser Bar Spring Washer		
624(830)	Feed Lifting Rock Shaft Bushing (front) Set Screw	2102	Tension Disc(2)		
		2974	Rotating Hook Bobbin Case Latch Lever Fulcrum Pin		
		2975	Rotating Hook Bobbin Case Latch Spring		
		4307	Bed Slide Spring		
		8582	Arm Dowel Pin(2)		

Numerical List of Parts for 281-20 Machine

NUMBER	DESCRIPTION	NUMBER	DESCRIPTION	NUMBER	DESCRIPTION
50117(830)	Feed Dog Screw(2)	140390(830)	Presser Foot Screw	143015	Arm Shaft (upright) Bevel Gear (upper) left hand spiral with two 1259(830) Note: To ensure proper functioning of Gears No. 143015 will not be supplied separately to Agencies, but will be substituted by Pair of Gears No. 147476
50123(805)	Oil Pump (centrifugal) Impeller Locking Screw	140410(830)	Arm Shaft (upright) Bushing (lower) Set Screw	143016-001	Arm Shaft (upright) Bushing (lower)
50123(819)	Tension Releasing Lever (adjustable) Screw	140427(830)	Feed Roll Guide Bar Adjusting Screw	143024	Bed Hole Plug
50190(809)	Guide Thumb Screw	140542(830)	Needle Bar Crank Position Screw	143031	Feed Bar Carrier Oil Wick
50203(830)	Presser Bar Guide Bracket Clamping Screw	140549(805)	Stitch Regulator Locking Slide Spring Screw	143040	Feed Lifting Rock Shaft Connecting Rod
50257(819)	Oil Flow Window Cap Screw(4)	140549(805)	Feed Roll Feed Regulator Locking Slide Spring Screw	143049	Feed Rock Shaft Connecting Rod
50305(803)	Tension Stud Set Screw	140553(805)	Oil Removing Wick (head end) Holder	143056	Needle Bar Connecting Link Roller Bearing(18)
50429(830)	Rotating Hook Shaft Oil Sling Set Screw(2)	140601(809)	Body Hinge Screw	143056	Thread Take-up Lever Roller Bearing(18)
50443(830)	Feed Roll Clutch Shaft Driving Crank Clamping Screw	140607(819)	Feed Roll Clutch Position Bracket Screw(2)	143058	Needle Bar Connecting Stud Slide Block
50470(804)	Feed Roll Driving Shaft (horizontal) Spur Gear and Feed Roll Shaft Spur Gear Cover Plate Screw(2)	140607(819)	Arm Top Cover (back) Stitch Regulator Plunger Hole Plug Screw (for plugging the Plunger Hole when the Plunger is removed to prevent tampering with the Stitch Set)	143061	Oil Flow Body Gasket(2)
50504(830)	Arm Shaft (upright) Bushing (upper) Set Screw	140610(819)	Arm Top Cover (front) Stitch Regulator Plunger Hole Plug Screw (for plugging the Plunger Hole when the Plunger is removed to prevent tampering with the Stitch Set)	143062	Oil Flow Window
50555(805)	Arm Shaft (horizontal) Plug Screw(2)	140610(819)	Arm Oil Plug Screw	143063	Oil Flow Window Cap
50579(809)	Feed Roll Driving Shaft (horizontal) Bevel Gear Cover Screw(2)	140705(805)	Thread Take-up Crank Clamping Screw Hole Plug Screw	143064	Oil Pipe
51283(830)	Machine Pulley Set Screw(2)	140706(803)	Arm Screw (back)	143065	Oil Pipe Clamping Sleeve
51369(813)	Arm Top Cover (front) Screw(4)	140788(805)	Needle Bar Connecting Stud Clamping Screw	143066	Oil Pipe Clamping Sleeve Nut
51369(805)	Oil Lead Screw	140873(803)	Feed Bar Hinge Pin Clamping Screw(2)	143070	Oil Pump (centrifugal) Body with 143126
51369(813)	Arm Top Cover (back) Screw(4)	140915(830)	Tension Stud	143071	Oil Pump (centrifugal) Body Position Pin(2)
51614(809)	Pressure Regulating Thumb Screw Lock Nut	141032(869)	Feed Lifting Rock Shaft Crank (front) Clamping Screw	143072	Oil Pump (centrifugal) Cover
51649(809)	Knee Lifter Rock Shaft Crank Adjusting Screw Lock Nut	141068(819)	Feed Roll Guide Bracket Screw(2)	143073	Oil Pump (centrifugal) Impeller
52083	Thread Take-up Spring Regulator with 50305(803)	141141(869)	Feed Roll Driving Shaft (horizontal) Spur Gear and Feed Roll Shaft Spur Gear Cover Screw(2)	143074	Oil Pump (centrifugal) Screen
52394	Thread Take-up Spring	141143(803)	Feed Roll Bracket Shaft Set Screw(2)	143075	Oil Pump (centrifugal) Screen Frame
52454	Thread Retainer	141188(803)	Feed Roll Eccentric Connecting Rod Hinge Screw	143081	Rotating Hook Shaft Bevel Gear (left hand spiral) with two 1259(830) Note: To ensure proper functioning of Gears No. 143081 will not be supplied separately to Agencies but will be substituted by Pair of Gears No. 143295
62527	Presser Foot Hinge Pin	141190(869)	Rotating Hook Oil Flow Regulating Thumb Screw	143082-001	Rotating Hook Shaft Bushing (back)
62926	Presser Foot Shank	141190(869)	Presser Foot Seat Adjusting Screw Note: No. 141190(869) is furnished on order only	143085	Feed Roll Feed Regulator
64519	Arm Top Cover (front) Stitch Regulator Plunger Spring	141201(805)	Arm and Bed Leg (back) Screw(2)	143085	Stitch Regulator
64519	Arm Top Cover (back) Stitch Regulator Plunger Spring	141202(805)	Arm Shaft (horizontal) Screw Plug (front)	143086	Feed Roll Feed Regulator Locking Slide
125320	Rotating Hook Bobbin Case Latch Lever	141208(830)	Thread Take-up Crank Clamping Screw	143086	Stitch Regulator Locking Slide
140036(803)	Needle Bar Thread Guard Screw	141240(803)	Feed Roll Guide Bar Screw(2)	143087	Feed Roll Feed Regulator Locking Slide Ratchet Wheel
140228(830)	Feed Lifting Rock Shaft Crank (back) Clamping Screw	141253(830)	Feed Roll Guide Bar Screw(2)	143087	Stitch Regulator Locking Slide Ratchet Wheel
140228(830)	Feed Rock Shaft Crank Clamping Screw	141253(830)	Knee Lifter Rock Shaft Crank Clamping Screw	143088	Feed Roll Feed Regulator Locking Slide Ratchet Wheel Pin
140230(803)	Feed Lifting Rock Shaft Connecting Rod Hinge Screw	141253(830)	Needle Lifter Rock Shaft Stop Dog Clamping Screw	143088	Stitch Regulator Locking Slide Ratchet Wheel Pin
140230(803)	Feed Rock Shaft Connecting Rod Hinge Screw	143013	Arm Shaft (upright)	143104	Bell Crank Hinge Pin
140231(803)	Needle Bar Connecting Link Cap Screw	143014	Arm Shaft (upright) Bevel Gear (lower) right hand spiral with two 1259(830) Note: To ensure proper functioning of Gears No. 143014 will not be supplied separately to Agencies, but will be substituted by Pair of Gears No. 143295	143108	Presser Bar and Feed Roll Lifting Lever Connecting Rod
140232(819)	Oil Wick Halder Screw			143109	Presser Bar and Feed Roll Lifting Lever Connecting Rod Swivel
140239(830)	Needle Set Screw			143124	Oil Pipe Clamping Sleeve
140256(830)	Feed Eccentric Stop Screw (7 stitch)			143125	Oil Pipe Clamping Sleeve Nut
140257(830)	Feed Eccentric Stop Screw (5-1, 2 stitch)			143126	Oil Pipe Clamping Sleeve Nut Adapter
140279(830)	Feed Roll Clutch Shaft Arm Bushing (front) Set Screw			143134	Feed Roll Feed Regulator 143085 with 140549(805), 143086 and 143378
140296(830)	Arm Shaft (horizontal) Bushing (center) Set Screw				
140297(830)	Arm Shaft (horizontal) Flanged Bushing (back) Set Screw				
140333(830)	Feed Lifting Eccentric Position Screw				
140343(805)	Machine and Machine Base Oil Reservoir Screw Hole Plug Screw				
140350(830)	Knee Lifter Rock Shaft Crank Adjusting Screw				
140359(805)	Feed Rock Shaft Oil Screw Plug				
140359(805)	Feed Lifting Rock Shaft Oil Screw Plug				

Numerical List of Parts for 281-20 Machine

NUMBER	DESCRIPTION	NUMBER	DESCRIPTION	NUMBER	DESCRIPTION
143134	Stitch Regulator 143085 with 140549(805), 143086 and 143378	147025-001	Feed Lifting Rock Shaft	147141	Oil Wick, 11 in. long for oiling Take-up Lever, Take-up Lever Link, Needle Bar Connecting Link and Thread Take-up Lever Link Hinge Bearing(2)
143191	Presser Bar and Feed Roll Lifting Lever Connecting Rod Oil Mist Retaining Disc (felt)	147028	Feed Lifting Rock Shaft Bushing (front)	147151	Tension Releasing Disc
143196	Needle Bar Oil Wick	147028	Feed Lifting Rock Shaft Bushing (back)	147152	Tension Spring
143236	Feed Lifting Rock Shaft Oil Screw Plug Washer (fiber)	147029	Feed Lifting Rock Shaft Collar with two 460(830)(2)	147158	Throat Plate (large needle hole) for use with 22834 and 161066
143236	Feed Rock Shaft Oil Screw Plug Washer (fiber)	147029	Feed Rock Shaft Collar with two 460(830)	147159	Tension Releasing Lever Body
143244	Arm Top Cover (back) Spool Pin with Spool Rest, 3-1/2 in. long	147030-001	Feed Lifting Rock Shaft 147025-001 with 13996, 147038 and suitable length of No. 1229 White Lighter Wicking	147160	Tension Releasing Lever Body (adjustable) 147159 with 50123(819) and 147161
143257	Machine Base and Oil Reservoir Gasket (cork)	147037	Feed Lifting Rock Shaft Oil Wick (short)(2)	147161	Tension Releasing Lever Segment
143268-001	Bed Leg (back)	147038	Feed Lifting Rock Shaft Oil Wick (long)	147166	Slack Thread Regulator Arm Top Cover (front) Gasket
143280-001	Knee Lifter Rock Shaft	147040-001	Feed Rock Shaft	147206	
143282	Knee Lifter Rock Shaft Crank Adjusting Screw 140350(803) with 51649(809)	147041-001	Feed Rock Shaft 147040-001 with 13996, 147046 and suitable length of No. 1229 White Lighter Wicking	147245	Oil Wick Holder with two 147141
143295	Pair of Gears for Lower Shaft, Nos. 143014 and 143081	147042	Feed Rock Shaft Bushing (back)	147247	Presser Bar Lifter
143301-001	Rotating Hook Oil Wick (felt)	147043	Feed Rock Shaft Bushing (front)	147250	Presser Bar and Feed Roll Lifting Lever Pin
143326	Needle Bar Connecting Stud with 140706(803)	147045	Feed Rock Shaft Oil Wick (short)	147290	Feed Lifting Rock Shaft Crank (front) with 140915(830)
143349-001	Rotating Hook Shaft Oil Filter Wick Holder	147046	Feed Rock Shaft Oil Wick (long)	147291	Presser Bar Spring
143351	Rotating Hook Wiper (leather)	147050-001	Needle Bar Connecting Link 147492-002 with 143326	147292	Tension Stud 140873(803) with two 1560(803)
143370	Oil Lead	147053	Needle Bar Connecting Stud Oil Wick	147293	Tension complete, Nos. 32574, 52083, 52394, 147151, 147152, 147292 and two 2102
143373	Bell Crank	147055	Oil Removing Wick (head end) Hinge Plate and Cover Gasket	147296	Thread Take-up Lever Oil Guard with 143196 and 147053
143374	Bell Crank Bracket	147057	Presser Bar (hollow)	147355	Feed Bar Carrier with two each 158(805) and 140788(805)
143375	Bell Crank Complete, Nos. 143104, 143373 and 143374	147058	Presser Bar Bushing (lower)	147356	Feed Bar Hinge Pin (eccentric)
143378	Feed Roll Feed Regulator Locking Slide Spring	147070	Thread Take-up Crank Clamping Screw Hole Plug Gasket	147394	Arm Shaft (horizontal) with 1036(830) and 140542(830)
143378	Stitch Regulator Locking Slide Spring	147073	Thread Take-up Lever Link Hinge Stud	147395	Combination of Feed Roll Feed Parts, Nos. 1662(819), 141144(803), 143087, 143134, 147472-001, 149042, 149046 and 149203
143383	Rotating Hook Oil Flow Regulating Thumb Screw Spring	147074	Thread Take-up Lever Link Hinge Stud Oil Wick	147396-001	Face Plate
143384	Oil Pipe for oiling Rotating Hook Shaft (front) Bearing	147075	Thread Take-up Lever Link Hinge Stud 147073 with 147074	147397	Face Plate Gasket
143387	Oil Pipe 143384 with 143124 for oiling Rotating Hook Shaft Front Bearing	147077	Thread Take-up Lever Guard Gasket	147398-001	Feed Roll (48 teeth) with 447(830) Note: No. 147398-001 is furnished on order only
146099	Feed Rock Shaft Crank with 140228(830)	147079	Thread Take-up Lever Thread Eyelet Bushing	147398-002	Feed Roll (32 teeth) with 447(830) Note: No. 147398-002 is furnished on order only
146552	Arm Screw (front and intermediate)(2)	147091	Pressure Regulating Thumb Screw and Presser Bar Guide	147399	Feed Roll and Presser Bar Lifting Lever Link
146580	Feed Roll Bracket Shaft Oil Retaining Wick Clip	147105	Arm Top Cover (back) Stitch Regulator Plunger	147400	Feed Roll Bracket with two 141141(869)
146580	Feed Roll Clutch Shaft Arm Bushing (front) Oil Wick Clip	147106	Oil Pipe complete from Oil Pump to Arm Shaft (horizontal) Center Bearing, Nos. 143064, 143065 and 143066	147402	Feed Roll Bracket Shaft
146591	Oil Flow Body	147107	Oil Removing Wick (head end)	147403	Feed Roll Bracket Shaft Bushing
146610	Presser Bar and Feed Roll Lifting Lever Spring	147108	Oil Removing Wick (head end) Holder Body 146745 with 146698 and 147107	147404	Feed Roll Bracket Pressure Spring
146698	Oil Removing Wick (head end) Holder Body Spring	147111-001	Arm Shaft (upright) Bushing (upper)	147405	Feed Roll Bracket Pressure Spring
146745	Oil Removing Wick (head end) Holder Body	147112-001	Arm Shaft (horizontal) Flanged Bushing (back)	147407	Feed Roll Bracket Shaft Guide Bracket Holder
146790	Arm Shaft (horizontal) Flanged Bushing (back) Oil Sump Tube	147114	Needle Bar Bushing (lower) Thread Eyelet	147408	Feed Roll Clutch (brake)
147005-001	Arm Shaft (horizontal) Flanged Bushing (front)	147131	Rotating Hook Shaft Oil Retaining Collar with two 50429(830)	147410	Feed Roll Clutch (brake) Bushing with two 453(830)
147008	Feed Roll Bracket Shaft Oil Retaining Wick	147139	Machine Pulley small rim diameter disc, power "V" belt groove 2.9 in. diam., with two 51283(830)	147411	Feed Roll Clutch (brake) Member Spring(3)
147011	Arm Top Cover (back) for 147013			147412	Feed Roll Clutch (drive)
147013	Arm Top Cover (back) with Stitch Regulator Plunger complete, Nos. 13288, 64519, 147011 and 147105				
147015	Arm Top Cover (back) Gasket				
147024	Feed Bar Carrier Oil Wick Holder with 143031				

Numerical List of Parts for 281-22 Machine

NUMBER	DESCRIPTION	NUMBER	DESCRIPTION	NUMBER	DESCRIPTION
147414	Feed Roll Clutch (drive) Member Spring(3)	147472-002	Feed Eccentric	149145	Rotating Hook (Air Cooled) 149142 with 149065 and three 1367(805)
147415	Feed Roll Clutch Body with two 443(830)	147473	Feed Lifting Eccentric and Arm Shaft (horizontal) Bevel Gear, right hand spiral with 1259(830), 140333(830) and 143088	149148	Rotating Hook Shaft with 149153
147416	Feed Roll Clutch Position Bracket		Note: To ensure proper functioning of Gears, No. 147473 will not be supplied separately to Agencies, but will be substituted by Pair of Gears No. 147476	149149	Rotating Hook Shaft 149148 with 147131
147417	Feed Roll Clutch Roller(6)	147476	Pair of Gears for Upper Shaft Nos. 143015 and 143473	149150-001	Rotating Hook Shaft Bushing (front)
147418	Feed Roll Clutch Roller Plunger(6)	147480	Knee Lifter Bell Crank Plunger	149152	Rotating Hook Shaft Oil Filter Wick
147419	Feed Roll Clutch Washer(2)	147482-001	Knee Lifter Rock Shaft Crank with 141253(830) and 143282	149153	Rotating Hook Shaft Oil Filter complete, Nos. 143349-001 and 149152
147420	Feed Roll Clutch Wearing Plate(6)	147483	Knee Lifter Rock Shaft Stop Dog with 141253(830)	149160	Thread Take-up Crank Wearing Plate
147421	Feed Roll Clutch and Shaft complete, Nos. 147408, 147410, 147412, 147415, 147422, 147427 two 147419, three each 147411, 147414 and six each 147417, 147418 and 147420	147485	Knee Lifter Rock Shaft Spring	149161	Thread Take-up Lever Guard
147422	Feed Roll Clutch Shaft	147486-001	Arm Shaft (horizontal) Bushing (center)	149166	Thread Eyelet and Thread Guard (front of arm)
147424	Feed Roll Clutch Shaft Arm Bushing (front) Oil Wick with 146580	147491	Machine Base and Oil Reservoir	149172	Rotating Hook (Air Cooled) 149142 with 149064, 149065 and three 1367(805)
147425-001	Feed Roll Clutch Shaft Arm Bushing (rear)	147492-002	Needle Bar Connecting Link	149173	Rotating Hook (Air Cooled) 149172 with 149063 and 149153
147426	Feed Roll Clutch Shaft Bevel Gear with two 462(830)	149016	Arm Top Cover (front)	149203	Feed Roll Clutch Shaft Driving Crank with 50443(830)
147426	Feed Roll Driving Shaft (horizontal) Bevel Gear with two 462(830)	149017	Arm Top Cover (front) with Stitch Regulator Plunger complete, Nos. 13288, 64519, 149016 and 149018	149205	Oil Removing Wick (head end) Hinge Plate and Cover
147427	Feed Roll Clutch Shaft Collar with two 460(830)	149018	Arm Top Cover (front) Stitch Regulator Plunger	149206	Oil Removing Wick (head end) Holder Body complete, Nos. 140553(805), 146698, 146745, 147055, 147107 and 149205
147429	Feed Roll Clutch Shaft Oil Retainer (felt)	149042	Feed Roll Eccentric Connecting Rod	149220-002	Needle Bar (hollow) with 140239(830)
147430	Feed Roll Driving Shaft (horizontal)	149046	Feed Roll Feed Regulator Locking Slide Ratchet Wheel Retaining Collar with 143088 and two 1259(830)	149223	Feed Roll Bracket Shaft Guide Bracket with 1353(830)
147431	Feed Roll Driving Shaft (horizontal) Bevel Gear Cover	149060	Rotating Hook Bobbin Case	149224	Oil Wick Holder Plug (felt)
147432	Feed Roll Driving Shaft (horizontal) Spur Gear	149061	Rotating Hook Bobbin Case 149060 with 591806(1), 1380(805) and 40394	149227	Presser Bar Bushing (lower) Washer
147433-001	Feed Roll Driving Shaft (horizontal) Spur Gear Pin (1 2 in. long)	149063	Rotating Hook Bobbin Case complete, Nos. 592(805), 2974, 2975, 40392, 125320 and 149061	149230	Arm Side Shield
147434	Feed Roll Driving Shaft (horizontal) Spur Gear and Feed Roll Shaft Spur Gear Cover	149064	Rotating Hook Bobbin Case Holder	149235-003	Needle Bar Thread Guard
147435	Feed Roll Driving Shaft (horizontal) Spur Gear and Feed Roll Shaft Spur Gear Cover Plate	149065	Rotating Hook Bobbin Case Holder	161065	Presser Foot Plate
147436	Feed Roll Driving Shaft (upright)	149066	Rotating Hook Section	161066	Presser Foot (spring hinged) complete, Nos. 62527, 62926, 161065 and 161160, for use with 22834 and 147158
147437	Feed Roll Driving Shaft (upright) Bevel Gear (upper) and (lower)	149074	Feed Lifting Rock Shaft Crank (back) with 140228(830)	161160	Presser Foot Spring
147438	Feed Roll Driving Shaft (upright) Driving Collar with two 1258(830)(2)	149111	Face Plate Plug (for plugging the Presser Bar adjustment hole)	272152	Rotating Hook Bobbin Needle Cat. No. 1955 (Size No. 16)
147439	Feed Roll Driving Shaft (upright) Hinge Pin (3 4 in. long)(2)	149118	Feed Roll Guide Bar	...	
147440	Feed Roll Shaft	149119	Feed Roll Guide Bracket		
147441	Feed Roll Shaft Spur Gear	149121	Machine Base and Oil Reservoir with Knee Lifter Rock Shaft, Nos. 143257, 143280-001, 147480, 147482-001, 147483, 147485 and 147491		
147442-001	Feed Roll Shaft Spur Gear Pin (3 8 in. long)	149124	Rotating Hook Bobbin Case Holder Position Bracket		
147443	Feed Roll Plate	149128-001	Thread Take-up Crank with Thread Take-up Lever with 149160 and eighteen 143056		
147444	Presser Bar Guide Bracket with 50203(830)	149130-002	Thread Take-up Crank and Thread Take-up Lever complete		
147445	Presser Bar and Feed Roll Lifting Lever with 454(830)	149141	Rotating Hook (Air Cooled) with 143301-001 and two 1253(830)		
147447	Presser Bar Lifting Bracket	149142	Rotating Hook (Air Cooled) 149141 with 143351, 149066 and four 1053(805)		
147449	Feed Roll Bracket Shaft Oil Retaining Wick 147008 with 146580				
147468	Arm Shaft (horizontal) Thrust Collar with two 624(830)				
147469	Combination of Feed and Stitch Regulator Parts, Nos. 143015, 143040, 143049, 143087, 143134, 147472-002 and 147473				
147470	Feed Bar				
147471	Feed Bar 147470 with 21478, 147290, 147355, 147356 and two 1423(803)				
147472-001	Feed Roll Eccentric				